

30/881

EH-60B16 NI-MH 80 mAh (SIZE): BUTTON CELL

Cell Dimension (With shrink sleeve)

Diameter	15.5 ± 0.7 mm
Height	6.3 ± 1.0 mm
Approximate Weight	5 g

Specifications

Nominal Voltage		1.2 V	
0.2C Discharge	Typical **	85 mAh	
	Nominal	80 mAh	
Capacity*	Standard	8 mA for 14 to 16hr	
	Fast	15 mA for 7 - 8 hr	
Life Expectancy		500 cycles	
Operating Temperature	Charge	Standard	0°C to 40°C
		Fast	10°C to 30°C
	Discharge		-10°C to 40°C
	Storage	<6 months	0°C to 35°C
<2 months		0°C to 45°C	

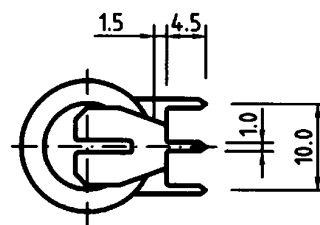
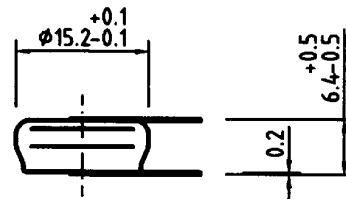

* After charging for 16 hr. with 0.1 C

** Average capacity

Charging curve of single cell EH-60B16-80mAh at 0.1C charging rate

Discharge curves of single cell EH-60B16 at -80mAh at various discharge rates at room temperature.

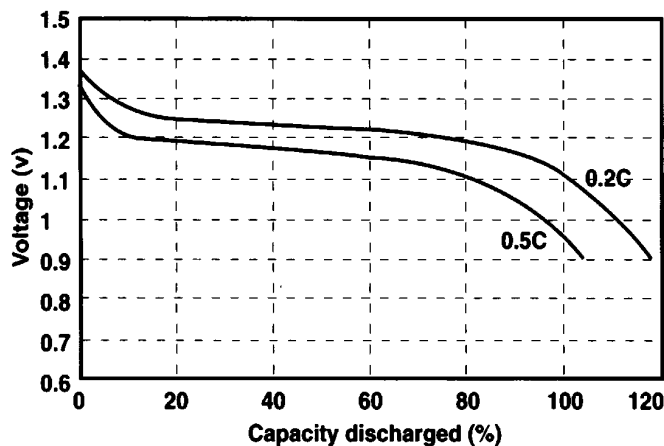
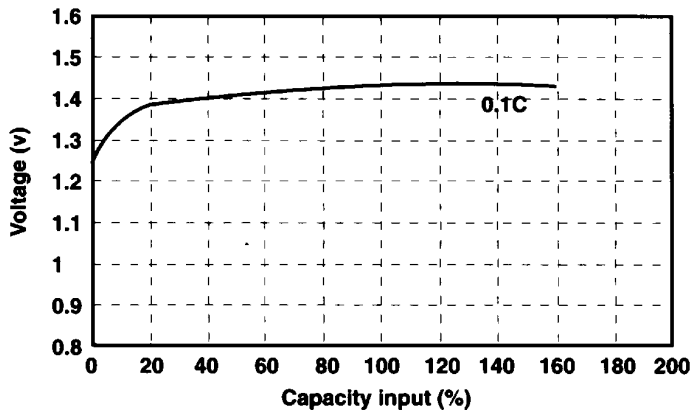

30/882

EH-60B16 NI-MH 80 mAh (SIZE): BUTTON CELL

Cell Dimension (With shrink sleeve)

Diameter	15.5 ± 0.7 mm
Height	12.5 ± 1.0 mm
Approximate Weight	9 g

Specifications

Nominal Voltage		2.4 V	
0.2C Discharge Capacity*	Typical **	85 mAh	
	Nominal	80 mAh	
Charge	Standard	8 mA for 14 to 16hr	
	Fast	15 mA for 7 - 8 hr	
Life Expectancy		500 cycles	
Operating Temperature	Charge	Standard	0°C to 40°C
		Fast	10°C to 30°C
	Discharge		-10°C to 40°C
	Storage	<6 months	0°C to 35°C
<2 months		0°C to 45°C	

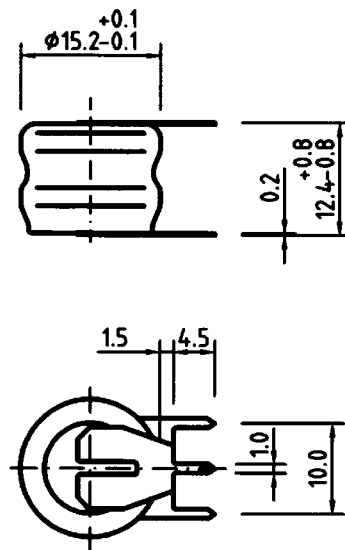

* After charging for 16 hr. with 0.1 C

** Average capacity

Charging curve of single cell EH-60B16 -80mAh at 0.1C charging rate

Discharge curves of single cell EH-60B16 at -8°C at various discharge rates at room temperature

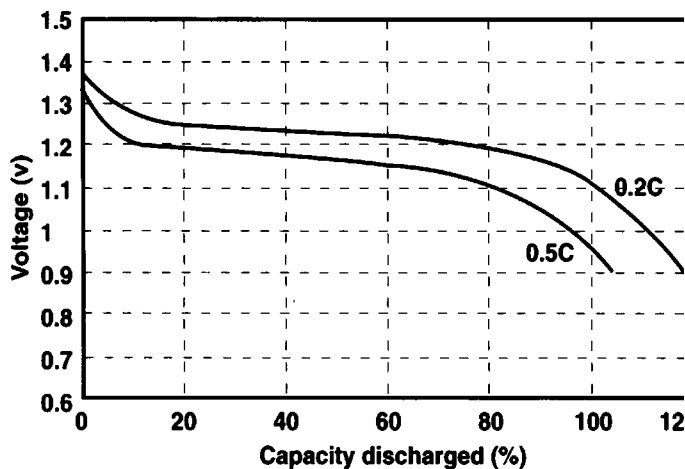
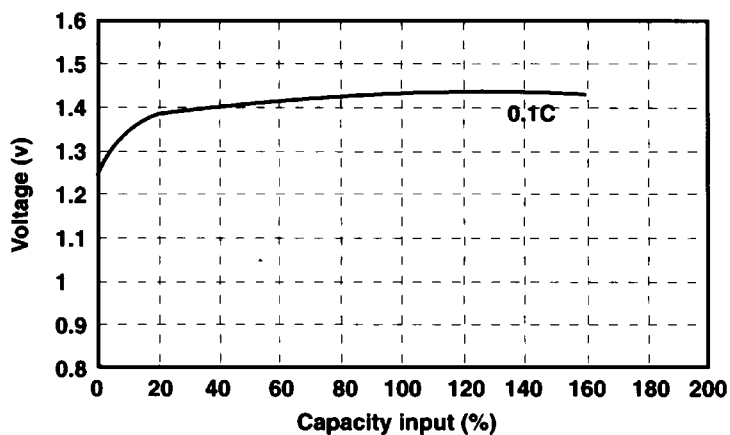

30/883

EH-60B16 NI-MH 80 mAh (SIZE): BUTTON CELL

Cell Dimension (With shrink sleeve)

Diameter	15.5 ± 0.7 mm
Height	18.5 ± 1.0 mm
Approximate Weight	13 g

Specifications

Nominal Voltage		3.6 V	
0.2C Discharge	Capacity*	Typical **	85 mAh
		Nominal	80 mAh
Charge		Standard	8 mA for 14 to 16hr
		Fast	15 mA for 7 - 8 hr
Life Expectancy		500 cycles	
Operating Temperature	Charge	Standard	0°C to 40°C
		Fast	10°C to 30°C
	Discharge		-10°C to 40°C
	Storage	<6 months	0°C to 35°C
<2 months		0°C to 45°C	

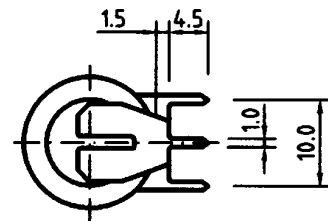
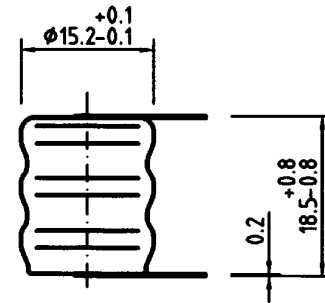

* After charging for 16 hr. with 0.1 C

** Average capacity

Charging curve of single cell EH-60B16 -80mAh at 0.1C charging rate

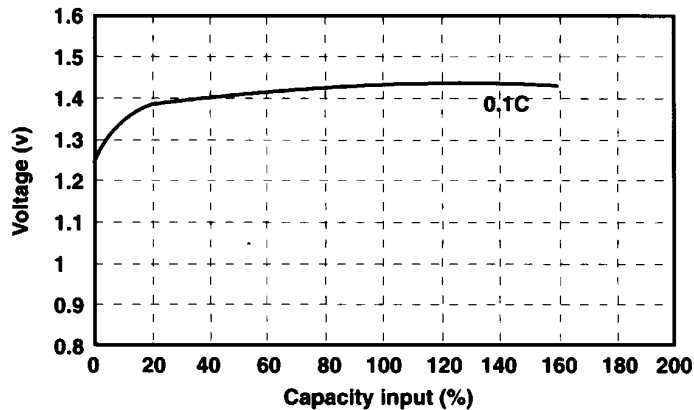

Discharge curves of single cell EH-60B16 at -80mAh at various discharge rates at room temperature.

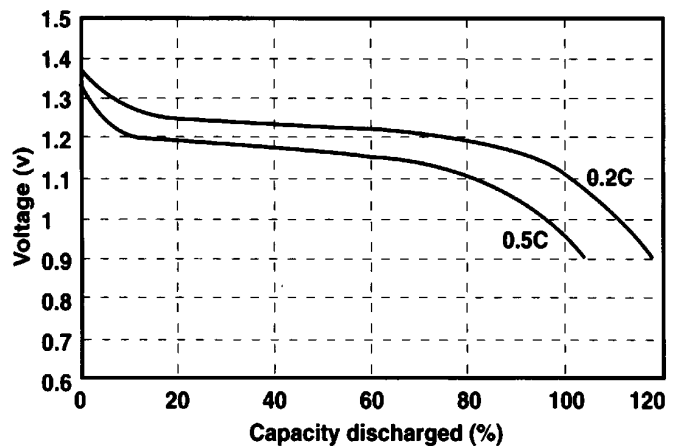

30/884

EH-60B16 NI-MH 80 mAh (SIZE): BUTTON CELL

Cell Dimension (With shrink sleeve)

Diameter	15.5 ± 0.7 mm
Height	24.5 ± 1.0 mm
Approximate Weight	18 g

Specifications

Nominal Voltage		4.8V	
0.2C Discharge	Capacity*	Typical **	85 mAh
		Nominal	80 mAh
Charge		Standard	8 mA for 14 to 16hr
		Fast	15 mA for 7 - 8 hr
Life Expectancy		500 cycles	
Operating Temperature	Charge	Standard	0°C to 40°C
		Fast	10°C to 30°C
	Discharge		-10°C to 40°C
	Storage	<6 months	0°C to 35°C
<2 months		0°C to 45°C	

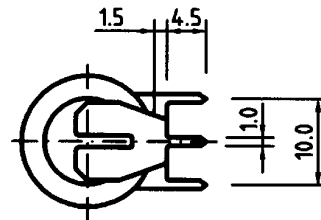
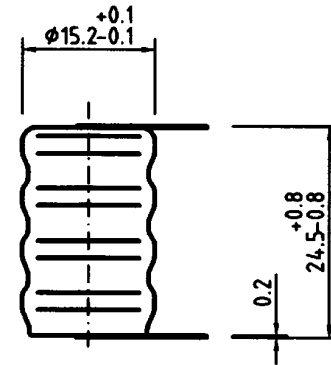

* After charging for 16 hr. with 0.1 C
 ** Average capacity

Charging curve of single cell EH-60B16-80mAh at 0.1C charging rate

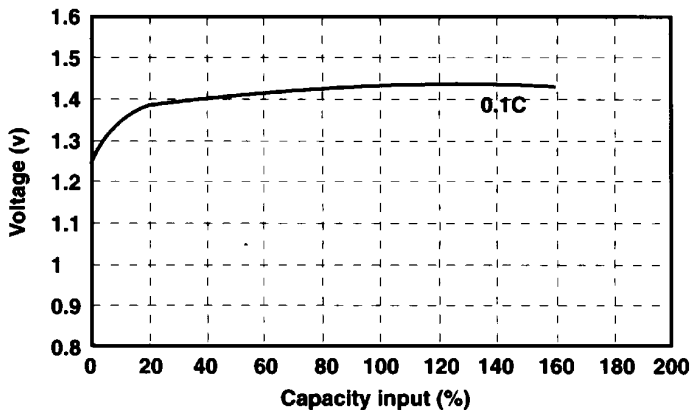

Discharge curves of single cell EH-60B16 at -80mAh at various discharge rates at room temperature.

